

PIANTA PIANO INTERRATO

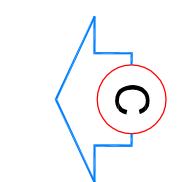

3740

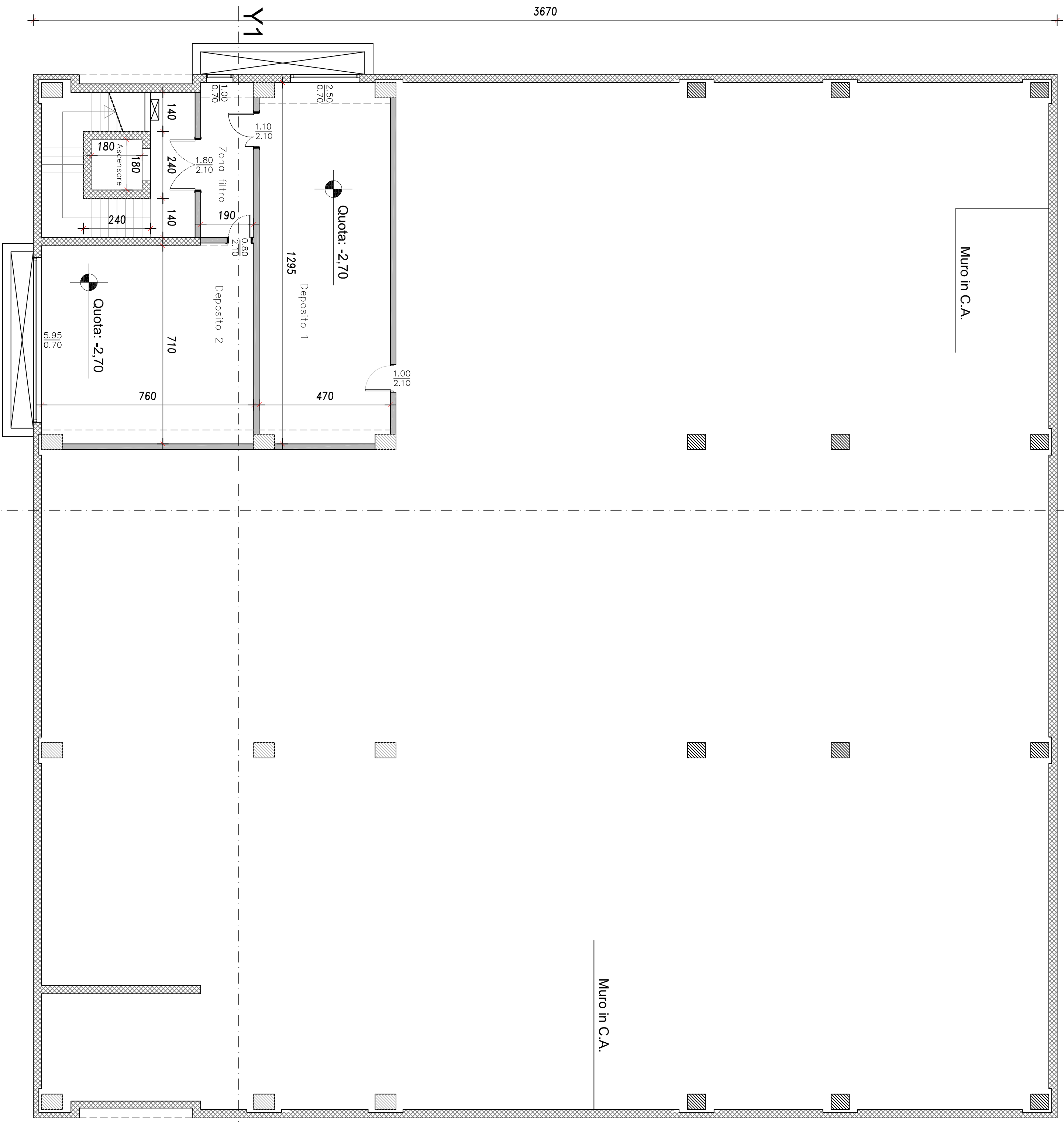

PIANTA PIANO TERRA

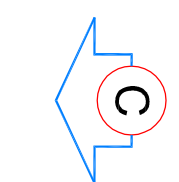

3720

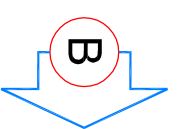
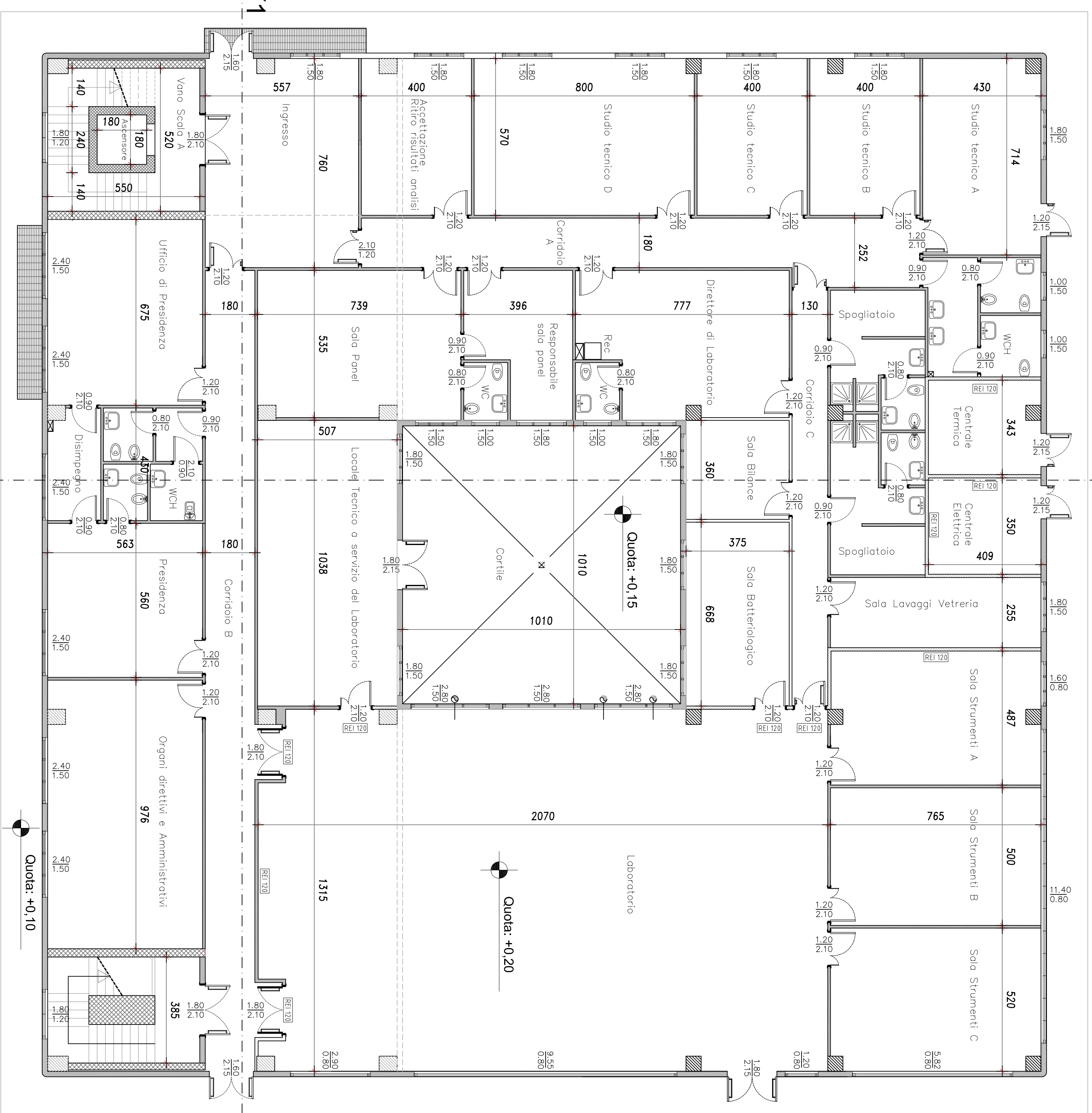

3670

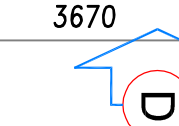

3670

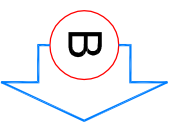

3650

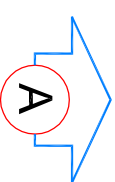
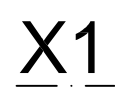

3740

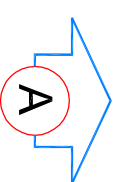

3720

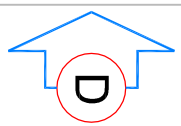

Camera di Commercio Brindisi

REALIZZAZIONE DELLA NUOVA SEDE CAMERALE
PRESSO LA "CITTADELLA DELLA RICERCA"
km 706+000 STRADA STATALE 7 APPIA

PROGETTO ESECUTIVO



RILIEVO PLANIMETRICO:
Planimetrie piani interrato e terra

03
1:100
12V

1:100

1:100

PROGETTAZIONE
Ing. Cesare ARGENTIER

RESPONSABILE UNICO DEL PROCEDIMENTO
Dott. Angelo Raffaele CAFORIO